

Hand Held Instrument

P
L
A
S
T
I
C



KEY FEATURES

- Electronic instrument enclosures, ideally suited for mounting printed circuit boards.
- Ergonomically designed for a comfortable fit into the user's hand.
- Two-piece lap joint construction provides protection against dust accumulation and splashing water.
- Molded in a choice of black or grey general purpose ABS plastic.
- Unit is secured with self-tapping screws.

ACCESSORIES



Replacement Screws

Package of 100 self-tapping #4 oval head:
CEM IS KS100 .875" (22.2mm) for K, L & X
CEM IS MS100 .625" (15.9mm) for S & T
CEM IS QS100 .75" (19.1mm) for J, N, P, Q, D & Y



Belt or Pocket Clip

Molded from tough nylon, includes 2 nylon screws and mounting template.
 Black - **CEM HH CLIP**
 Grey - **CEM HH CLIPGY**



P.C. Board Screws

Self-tapping type, used for bosses in the CEM PCB lid for P.C. board installation. #4 x 1/4" (6.4 mm)
CEM IS ATS50 - Package of 50
CEM IS ATS100 - Package of 100

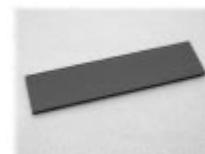

Optional Infrared Panel

Sold in packages of 10
CEM IS DIR10 for CEM IS D
CEM IS NIR10 for CEM IS N
CEM IS PIR10 for CEM IS K, L, P, Q, Y & X
CEM IS SIR10 for CEM IS S & T

Recessed top for membrane display or pad

Four P.C. card standoffs molded in bottom

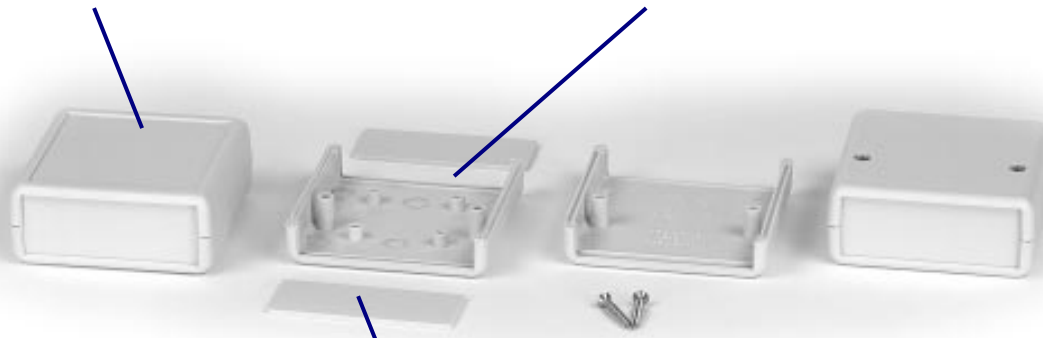

Removable front & rear panels for easy modification (or replace with optional IR panel) - sized to accept most popular connectors

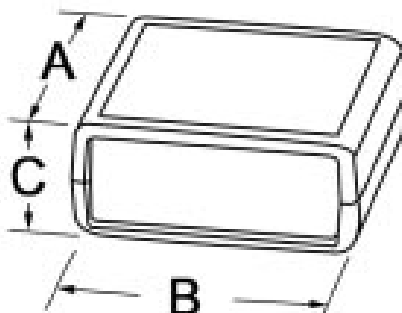

REFERENCE		Dimensions			Battery Compartment	Front Open (w/panel)	Rear Open (w/panel)
Black	Grey	A	B	C			
CEM IS – KBK	CEM IS – KGY	66	66	28	NO	Y	Y
CEM IS – LBK	CEM IS – LGY	92	66	28	NO	Y	Y
CEM IS – NBK	CEM IS – NGY	110	75	25	NO	Y	Y
CEM IS – XBK	CEM IS – XGY	140	66	28	NO	Y	Y

NOTE: CEM IS – N is designed to house the smart card readers.

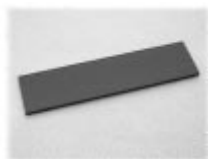

Optional Infrared Panel

Sold in packages of 10
CEMIS NIR10 for CEMIS N
CEMIS PIR10 for CEMIS K, L & X



Replacement Screws

Package of 100 self-tapping #4 oval head:
CEMIS KS100 .875" (22.2mm) for K, L & X
CEMIS QS100 .75" (19.1mm) for N



P.C. Board Screws

Self-tapping type, used for bosses in the 1591 lid for P.C. board installation.
#4 x 1/4" (6.4 mm)
CEMIS ATS50 - Package of 50
CEMIS ATS100 - Package of 100

Recessed top for membrane display or pad

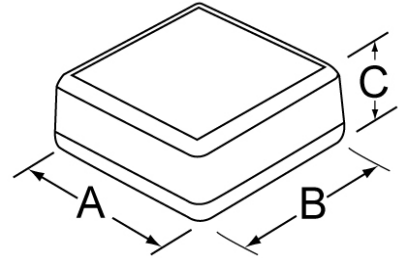
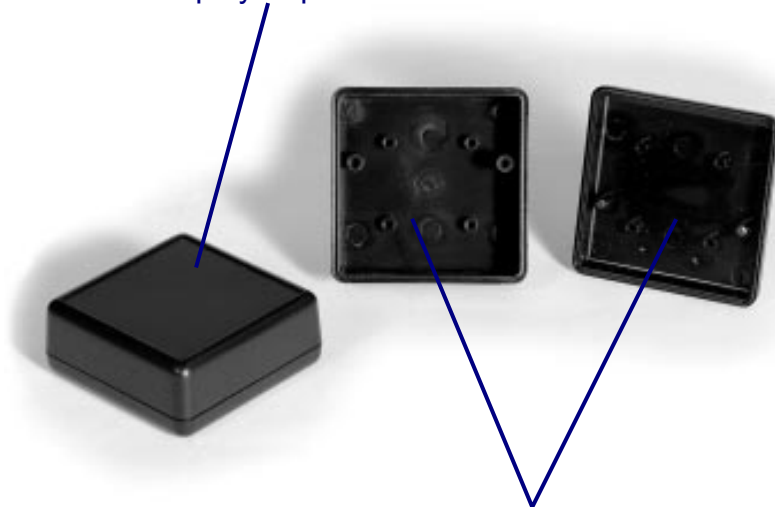

Four P.C. card standoffs molded in both halves

REFERENCE		Dimensions			Battery Compartment	Front Open (w/panel)	Rear Open (w/panel)
Black	Grey	A	B	C			
CEM IS – JBK	CEM IS – JGY	66	66	28	NO	NO	NO

Replacement Screws

Package of 100 self-tapping #4 oval head:
CEMIS QS100 .75" (19.1mm)

PCB Screws

To mount P.C. boards into standoffs
(#4 x 1/4" pan head screws)
CEMIS ATS100 - Package of 100
CEMIS ATS50 - Package of 50

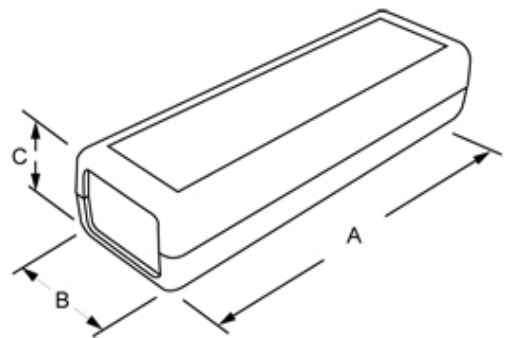

REFERENCE		Dimensions			Battery Compartment	Front Open (w/panel)	Rear Open (w/panel)
Black	Grey	A	B	C			
CEM IS – DBK	CEM IS – DGY	114	36	25	NO	Y	Y

Optional Infrared Panel

CEMIS DIR10 - Package of 10

Replacement Screws

Package of 100 self-tapping #4 oval head:
CEMIS QS100 .75" (19.1mm)

PCB Screws

To mount P.C. boards into standoffs
(#4 x 1/4" pan head screws)
CEMIS ATS100 - Package of 100
CEMIS ATS50 - Package of 50

Recessed top for membrane display or pad

Four vertical P.C. card guides molded in

Long life battery door with our "three snap" location door

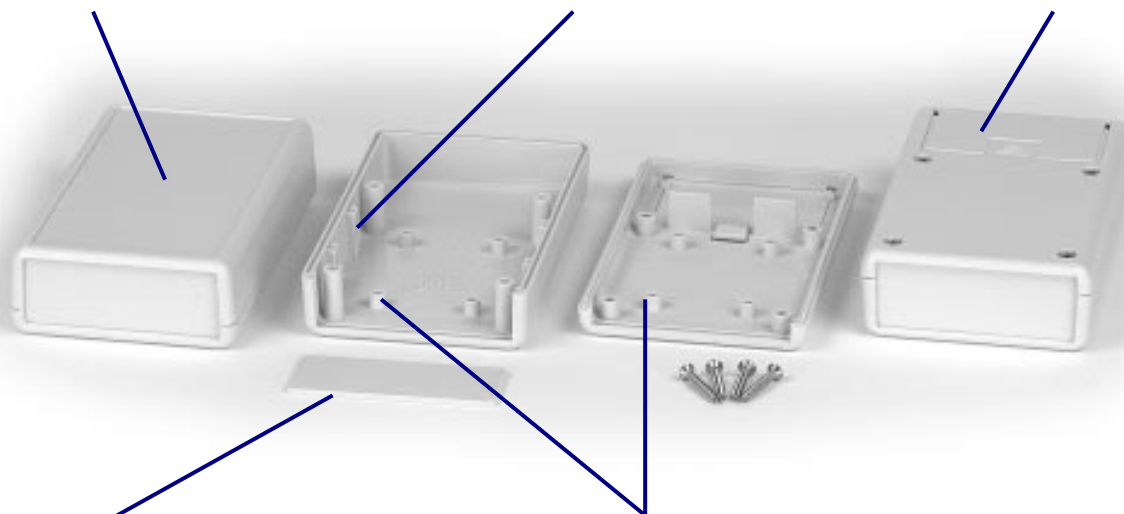

Removable front panel (or replace with optional IR panel) for easy modification - sized to accept most popular connectors

P.C. card standoffs molded in both halves

REFERENCE		Dimensions			Battery Compartment	Front Open (w/panel)	Rear Open (w/panel)
Black	Grey	A	B	C			
CEM IS – SBK	CEM IS – SGY	92	66	21	Y*	Y	NO
CEM IS – PBK	CEM IS – PGY	92	66	28	Y	Y	NO
CEM IS – TBK	CEM IS – TGY	112	66	21	Y*	Y	NO
CEM IS – QBK	CEM IS – QGY	112	66	28	Y	Y	NO
CEM IS – YBK	CEM IS – YGY	140	66	28	Y	Y	NO

NOTES: * Due to their low profile design, the CEM IS – S & CEM IS – T models will not accept batteries larger than AAA.

Battery Holder Kits

- Designed for our battery door enclosures.
- Kits include all the parts required to install the batteries
- Kit includes the battery holder, wires, divider and foam anti-rattle pad.

Part Number	Battery holder kit for:
BH1AAWKIT	1 AA Cell
BH2AAWKIT	2 AA Cells
BH1AAAWKIT	1 AAA Cell
BH2AAAWKIT	2 AAA Cells
BH3AAAWKIT	3 AAA Cells
BH4AAAWKIT	4 AAA Cells
BS61KIT	1 - 9V Cell

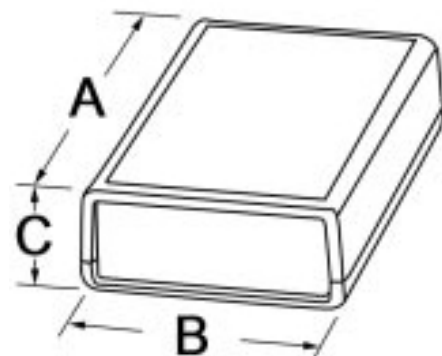

Optional Infrared Panel

Package of 10

CEMIS PIR10 - for CEMIS P, Q & Y

CEMIS SIR10 - for CEMIS S & T

Replacement Screws

Package of 100 self-tapping #4 oval head:

CEMIS MS100 .625" (15.9mm) for

CEMIS S & T

CEMIS QS100 .75" (19.1mm) for CEMIS P, Q & Y

PCB Screws

To mount P.C. boards into standoffs

(#4 x 1/4" pan head screws)

CEMIS ATS100 - Package of 100

CEMIS ATS50 - Package of 50